

RIVNUTS

Body:

STEEL

Head:

CSK / Low Profile / Thin Head

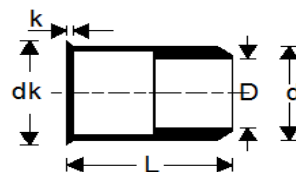

Code	Size (D)	Head Diameter (dk) +0.30 -0.30	Head Thickness (k) +0.20 -0.20	Outer Diameter of Shank (d)	Total Length (L) +0.30 -0.30	Hole Size	Grip Range 
	(mm)	(mm)	(mm)	(mm)	(mm)	(mm)	(mm)
RIV-CSK	M3	6.0	0.5	4.9	9.0	5	0.5-2.0
	M4	7.0	0.5	5.9	11.0	6	0.5-2.0
	M5	8.0	0.5	6.9	11.5	7	0.5-2.0
	M6	10.0	0.6	8.9	14.0	9	0.5-2.5
	M8	12.0	0.6	10.9	16.5	11	1.0-3.0
	M10	14.0	0.7	12.9	19.5	13	1.0-3.5



RIVNUTS

Body:

STEEL

Head:

Flat Head / Large Flange

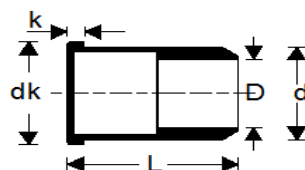

Code	Size (D)	Head Diameter (dk) +0.30 -0.30	Head Thickness (k) +0.20 -0.20	Outer Diameter of Shank (d)	Total Length (L) +0.30 -0.30	Hole Size	Grip Range 
	(mm)	(mm)	(mm)	(mm)	(mm)	(mm)	(mm)
RIV-LF	M4	9.0	0.8	5.9	10.5	6	0.5-2.0
	M5	10.0	1.0	6.9	13.0	7	0.5-2.5
	M6	12.3	1.3	8.9	15.5	9	0.5-3.0
	M8	14.5	1.5	10.9	18.5	11	1.0-3.5
	M10	17.0	1.7	12.9	21.0	13	1.0-3.5
	M12	22.0	2.0	15.9	25.0	16	1.0-3.5



RIVNUTS

Body:

STEEL (Longer)

Head:

Flat Head / Large Flange

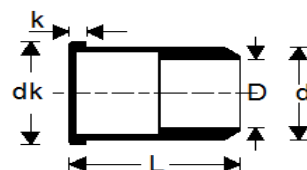

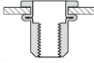
Code	Size (D)	Head Diameter (dk) +0.30 -0.30	Head Thickness (k) +0.20 -0.20	Outer Diameter of Shank (d)	Total Length (L) +0.30 -0.30	Hole Size	Grip Range 
	(mm)	(mm)	(mm)	(mm)	(mm)	(mm)	(mm)
RIV-LF(L)	M5	10.0	1.0	6.9	16.5	7	2.5-5.0
	M6	12.3	1.3	8.9	19.5	9	3.0-5.5
	M8	14.5	1.5	10.9	21.0	11	3.5-6.0
	M10	17.0	1.7	12.9	24.0	13	4.0-6.5



RIVNUTS

Body:

STAINLESS STEEL

Head:

CSK / Low Profile / Thin Head

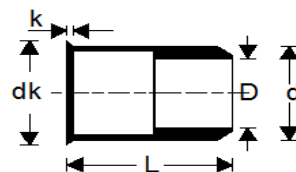

Code	Size (D)	Head Diameter (dk) +0.30 -0.30	Head Thickness (k) +0.20 -0.20	Outer Diameter of Shank (d)	Total Length (L) +0.30 -0.30	Hole Size	Grip Range 
	(mm)	(mm)	(mm)	(mm)	(mm)	(mm)	(mm)
RIV-CSK	M4	7.0	0.5	5.9	10.5	6	0.5-2.0
	M5	8.0	0.5	6.9	11.5	7	0.5-2.0
	M6	10.0	0.6	8.9	14.0	9	0.5-2.5
	M8	12.0	0.6	10.9	16.5	11	1.0-3.0
	M10	14.0	0.7	12.9	17.7	13	1.0-3.5



RIVNUTS

Body:

STAINLESS STEEL

Head:

Large Flange / Flat Head

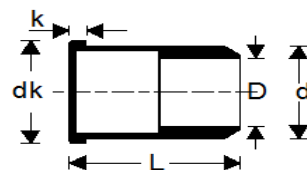

Code	Size (D)	Head Diameter (dk) +0.30 -0.30	Head Thickness (k) +0.20 -0.20	Outer Diameter of Shank (d)	Total Length (L) +0.30 -0.30	Hole Size	Grip Range 
	(mm)	(mm)	(mm)	(mm)	(mm)	(mm)	(mm)
RIV-LF	M4	9.0	0.8	5.9	10.5	6	0.5-2.0
	M5	10.0	1.0	6.9	13.0	7	0.5-2.0
	M6	12.3	1.3	8.9	15.5	9	0.5-2.5
	M8	14.5	1.5	10.9	18.5	11	1.0-3.0
	M10	17.0	1.6	12.9	21.0	13	1.0-3.5



RIVNUTS

Body:

ALUMINIUM

Head:

Large Flange / Flat Head

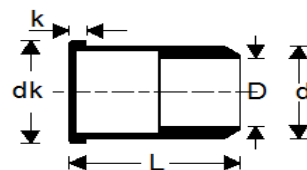

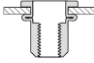
Code	Size (D)	Head Diameter (dk) +0.30 -0.30	Head Thickness (k) +0.20 -0.20	Outer Diameter of Shank (d)	Total Length (L) +0.30 -0.30	Hole Size	Grip Range 
	(mm)	(mm)	(mm)	(mm)	(mm)	(mm)	(mm)
RIV-LF	M3	7.0	0.8	4.9	9.0	5	0.5-2.0
	M4	9.0	0.8	5.8	11.0	6	0.5-2.0
	M5	10.0	1.0	6.9	13.0	7	0.5-2.5
	M6	13.0	1.5	8.8	15.0	9	0.5-3.0
	M8	15.0	1.6	10.9	16.5	11	0.5-3.5



RIVNUT APPLICATION

LF
Top View



CSK
Top View



Large
Flange
Side View



CSK / Low
Profile
Side View



Underside
View



CSK / Low
Profile
Side View

